

FED. ROAD DIST. NO.	STATE	FED. AID PROJ. NO.	FISCAL YEAR	SHEET NO.	TOTAL SHEETS
UT.	UTAH	S-0568(1)	POST WAR	3	

PLAN	DATE	BY
REVISED	8.2.74	H.M. FEHRELL
NOTE BOOK		
ALIGNED CHECKED		
PT. OF WAY CHECKED		
NO.		

PROFILE	DATE	BY
REVISED	8.2.74	H.M. FEHRELL
NOTE BOOK		
GRADES CHECKED		
B. M. NOTED		
NO. 8782		
STRUCTURE NOTATIONS CHG.		

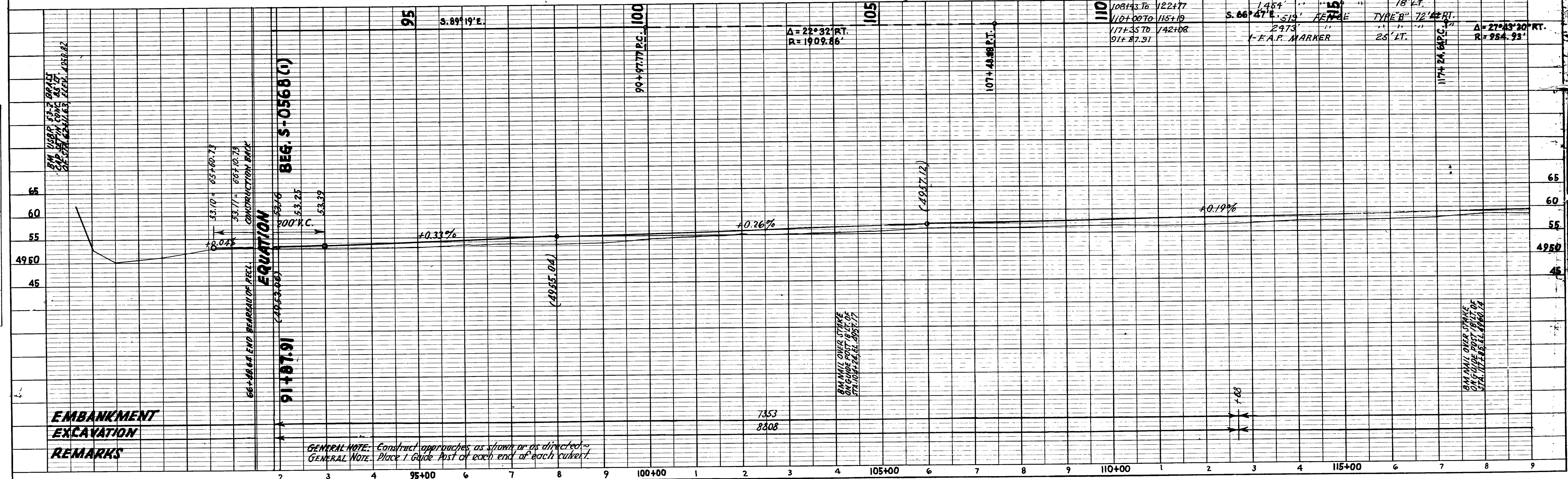
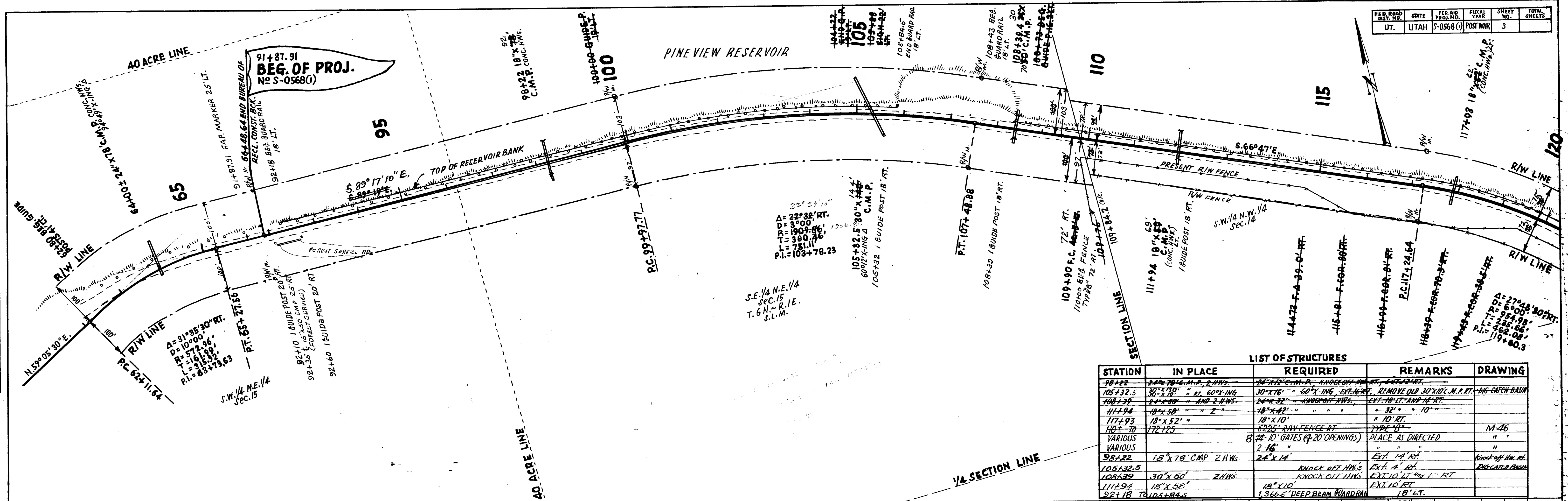

STATION	IN PLACE	REQUIRED	REMARKS	DRAWING
98+22	30"x12" C.M.P.	24"x12" C.M.P.	KNOCK OFF H.W.S. EXT. 14' RT.	
103+32.5	30"x12" RT. 60"x12" ING.	30"x12" 60"x12" ING. EXT. 16' RT.	REMOVE OLD 30"x12" M.A. RT. - BIG CATCH BASIN	
108+39	24"x32" AND 2 HWS.	24"x32" KNOCK OFF HWS.	EXT. 10' LT. HWP 14' RT.	
111+94	18"x50" "	18"x42" "	" 32' " 10' "	
117+93	18"x52" "	18"x10' "	" 10' RT.	
140+70	172' 125'	6225' R/W FENCE RT.	TYPE 'B'	M-46
VARIOUS		8' 10' GATES (4-20' OPENINGS)	PLACE AS DIRECTED	"
		2-16' "	"	"
98+22	18"x78" CMP 2 HWS.	24"x14' "	EXT. 14' RT.	Knock-off line rd.
105+32.5	30"x60' 2 HWS.	KNOCK OFF HWS.	EXT. 4' RT.	DIG CATCH BASIN
108+39	18"x50' "	18"x10' "	EXT. 10' LT. 10' RT.	
111+94	18"x50' "	18"x10' "	EXT. 10' RT.	
92+18	104+84.5	1366.5' DEEP BEAM GUARD RAIL	18' LT.	
108+43.76	122+77	1454' "	18' LT.	
110+00 TO 115+19	S. 66°47' E 513' FENCE	TYPE 'B' 72' RT.		
117+35 TO 142+08	" 2473' "	" "		
91+87.91	1-E.A.P. MARKER	25' LT.		A=27°43' 30" RT. R=954.93'

GENERAL NOTE: Construct approaches as shown or as directed.
GENERAL NOTE: Place 1 Guide Post of each end of each culvert.